

USB RETENTION MOUNT ASSEMBLY INSTRUCTIONS

- 1 Unplug and remove ALL cords from your Expansion Hub. Ensure the Mini USB port area is clear. Use the included cleaning cloth to wipe down the areas shown. Let dry.

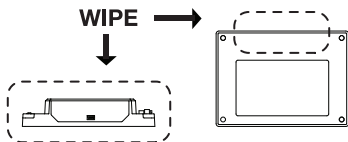

- 2 Locate the Case Safety Sticker in your kit. Before removing the backing from your Case Safety Sticker, practice using the alignment marks to place the sticker in alignment with your Hub's Mini USB port.

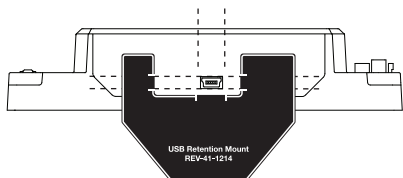

- 3 When ready, remove the backing. First, press only the top half firmly in place, where the alignment marks match up with your Hub's Mini USB port.

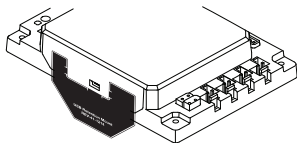

- 4 Once the top half is in place, firmly and evenly pull the bottom portion down onto the back of your Hub. Apply pressure to make sure it is completely secured.

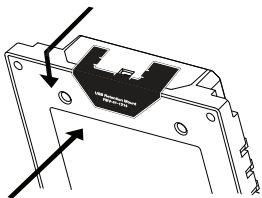

- 5 Press Cable Head into Cable Cap.

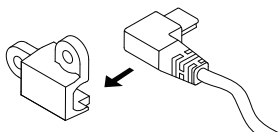

- 6 Insert into the Base Plate.

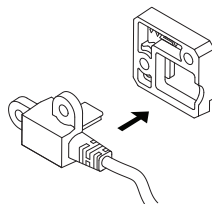

- 7 Screw the pieces together.

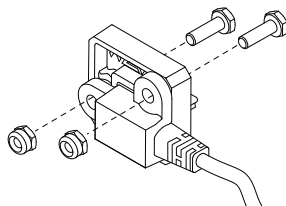

- 8 Peel the backing off of the Adhesive Pad on the Base Plate facing side. Do not remove the backing from the Expansion Hub facing side.

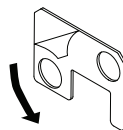

- 9 Apply the Adhesive Pad to the back of the Base Plate.

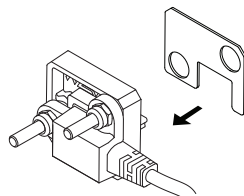

- 10 Before removing the backing from the Expansion Hub facing side of the Adhesive Pad, practice placing the Retention Mount on your Hub. Make sure the cable plugs into the port cleanly.

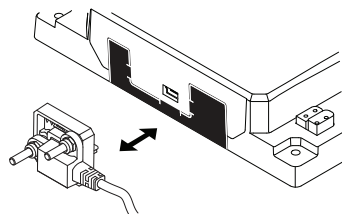

- 11 Once ready, peel the backing off of the Adhesive Pad and place the Retention Mount on your Hub. Hold the Mount in place while applying firm pressure for 30 seconds. The Hub will be safe to handle after sitting for 5 min, and the adhesive will be fully set in 24 hours.

DONE!